

09/08/24

PROJECT: 18313.1059011.PR

CONTRACT: DM00484

See Sheet 1A For Index of Sheets

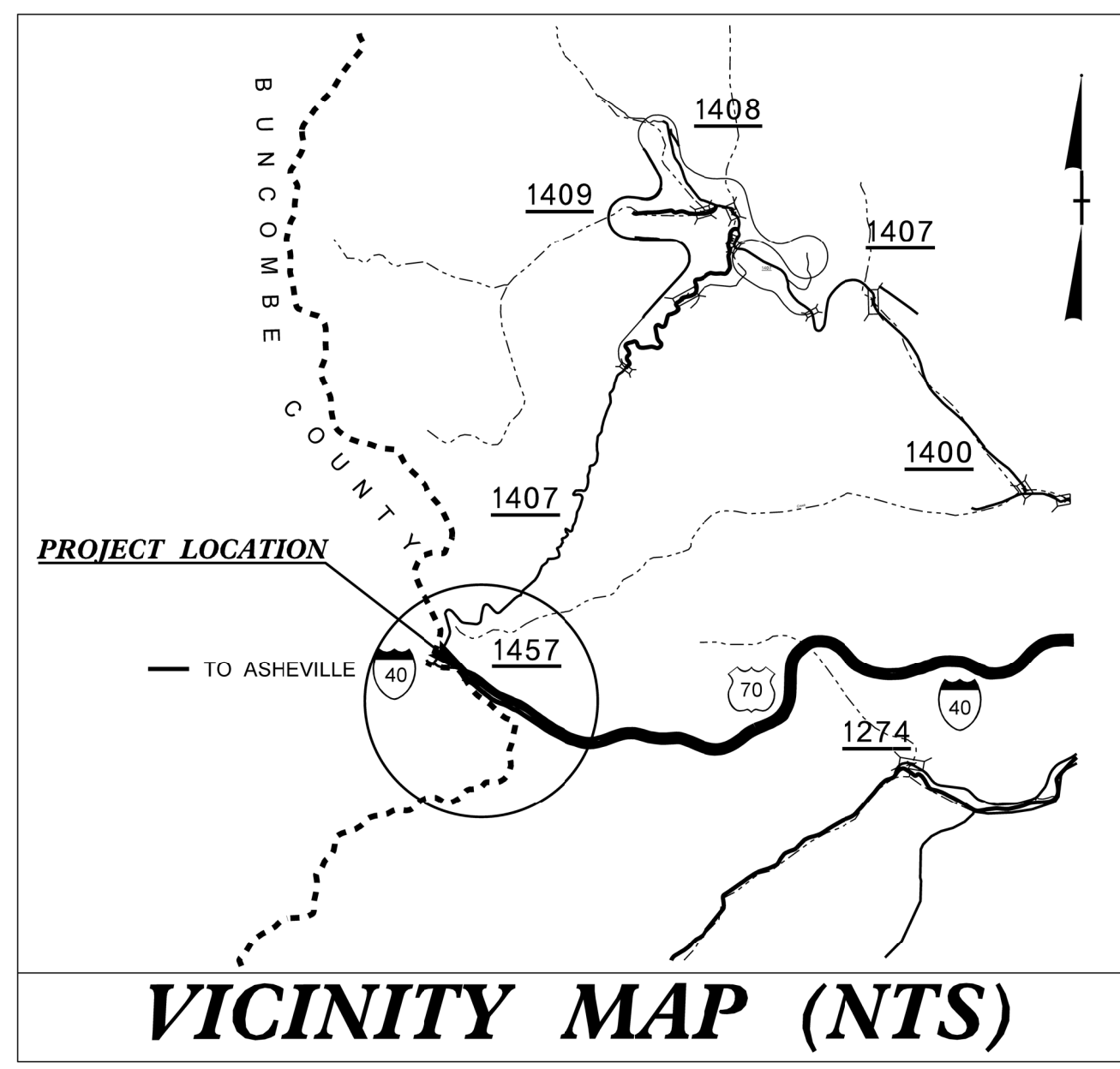

STATE OF NORTH CAROLINA
 DIVISION OF HIGHWAYS
MCDOWELL COUNTY

LOCATION: I-40 MILE MARKER 67.4

TYPE OF WORK: TRENCHLESS PIPE INSTALLATION

STATE	STATE PROJECT REFERENCE NO.	SHEET NO.	TOTAL SHEETS
N.C.	18313.1059011.PR	1	
STATE PROJ. NO.	F.A. PROJ. NO.	DESCRIPTION	

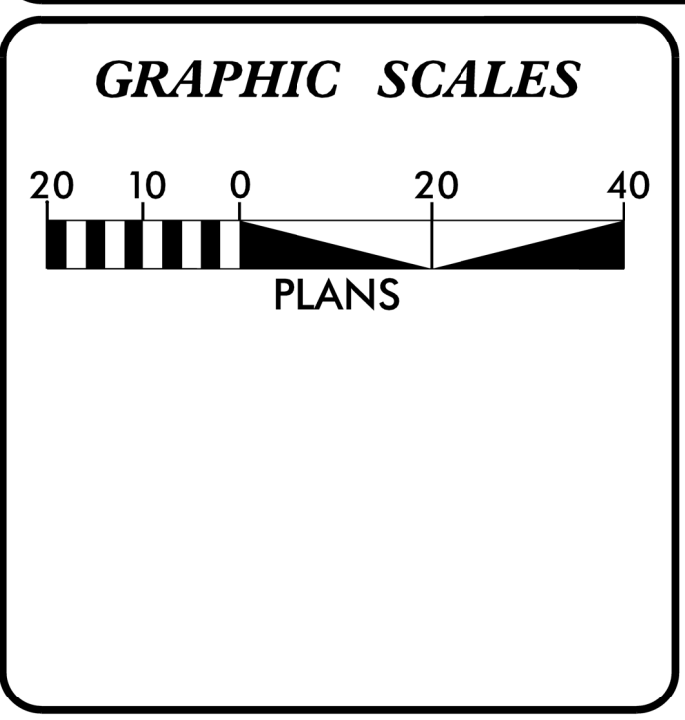
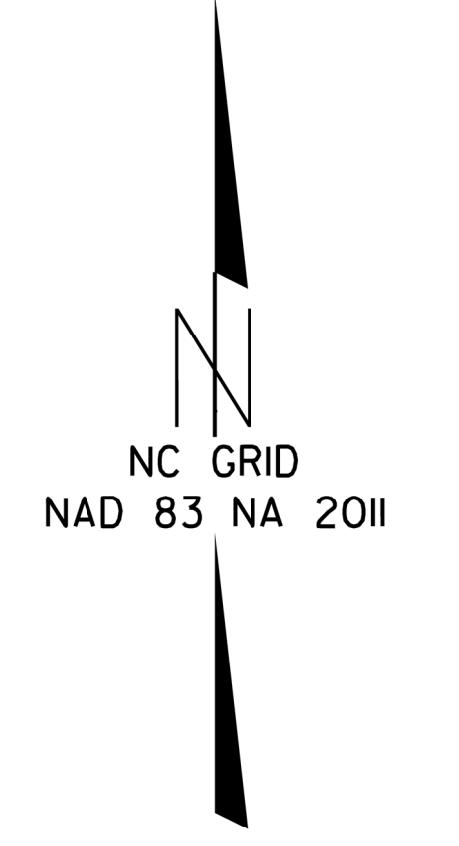
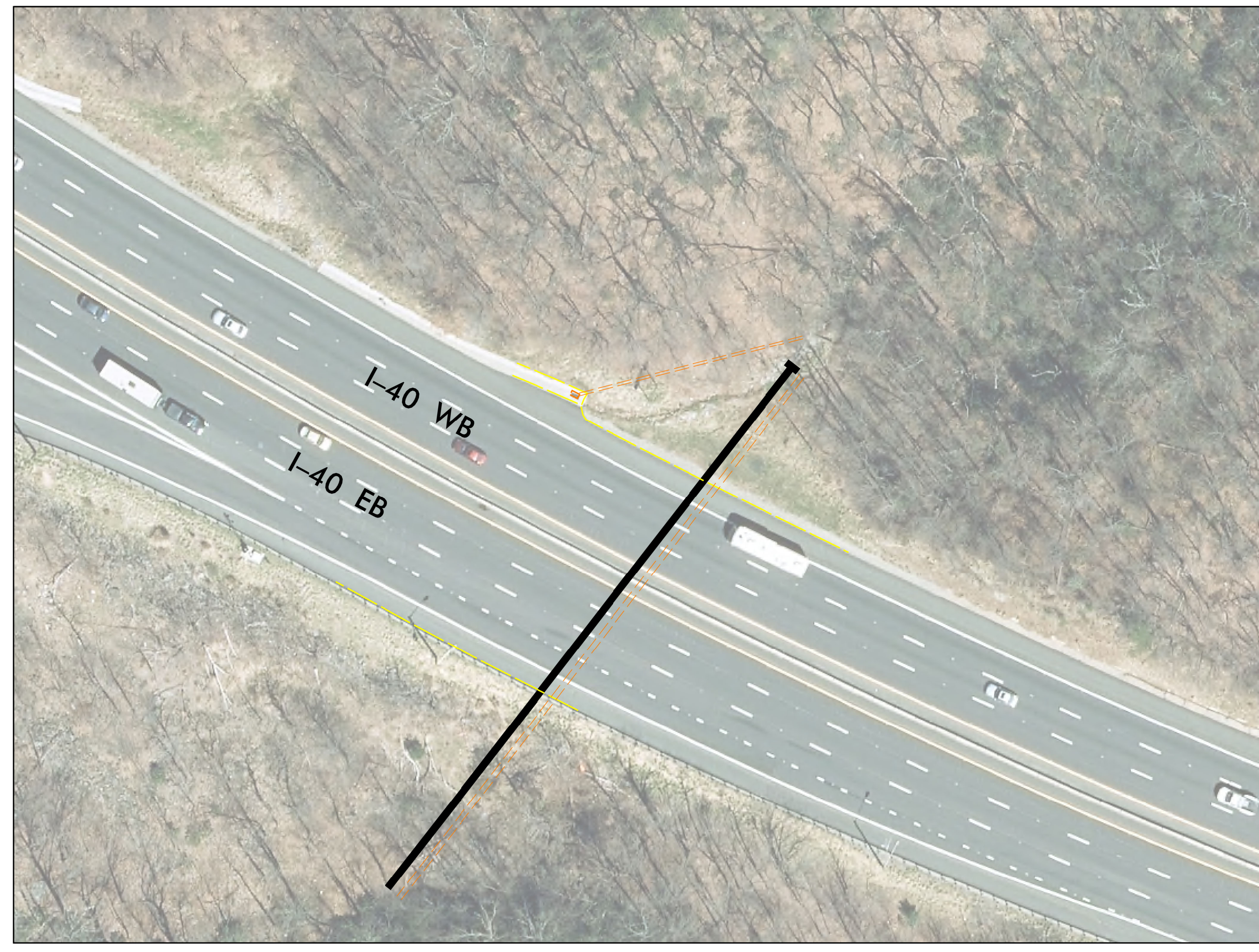

Prepared In the Office of:
DIVISION OF HIGHWAYS
 55 Orange Street., Asheville NC, 28801

2024 STANDARD SPECIFICATIONS

LETTING DATE: DECEMBER 3, 2025	CHAD YOUNG PROJECT ENGINEER <hr/> WILLIAM C. CARVER PROJECT DESIGN ENGINEER
------------------------------------------	----------------------------------------------------------------------------------------------------

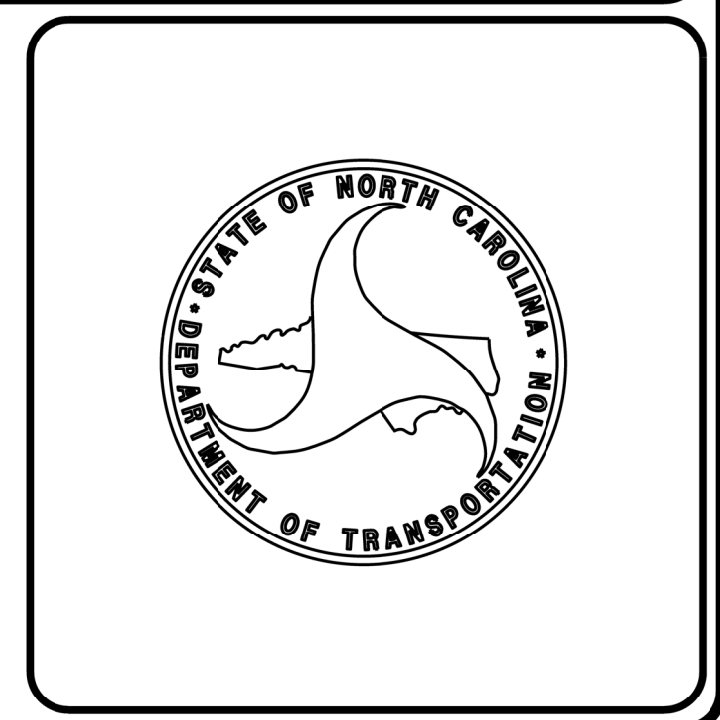

\$\$\$\$\$SYTIME\$\$\$\$\$
\$\$\$\$\$DCN\$\$\$\$\$
\$\$\$\$\$USERNAME\$\$\$\$\$



REVISIONS

S:\MAR_2025_0951\Wc\Devel\1\40_01\For-MtrnPipe_2025\Roadway\Proc\140_ddc_psh_01\OfFactPipe.dgn
 2:100% Plot Date: 8/17/99

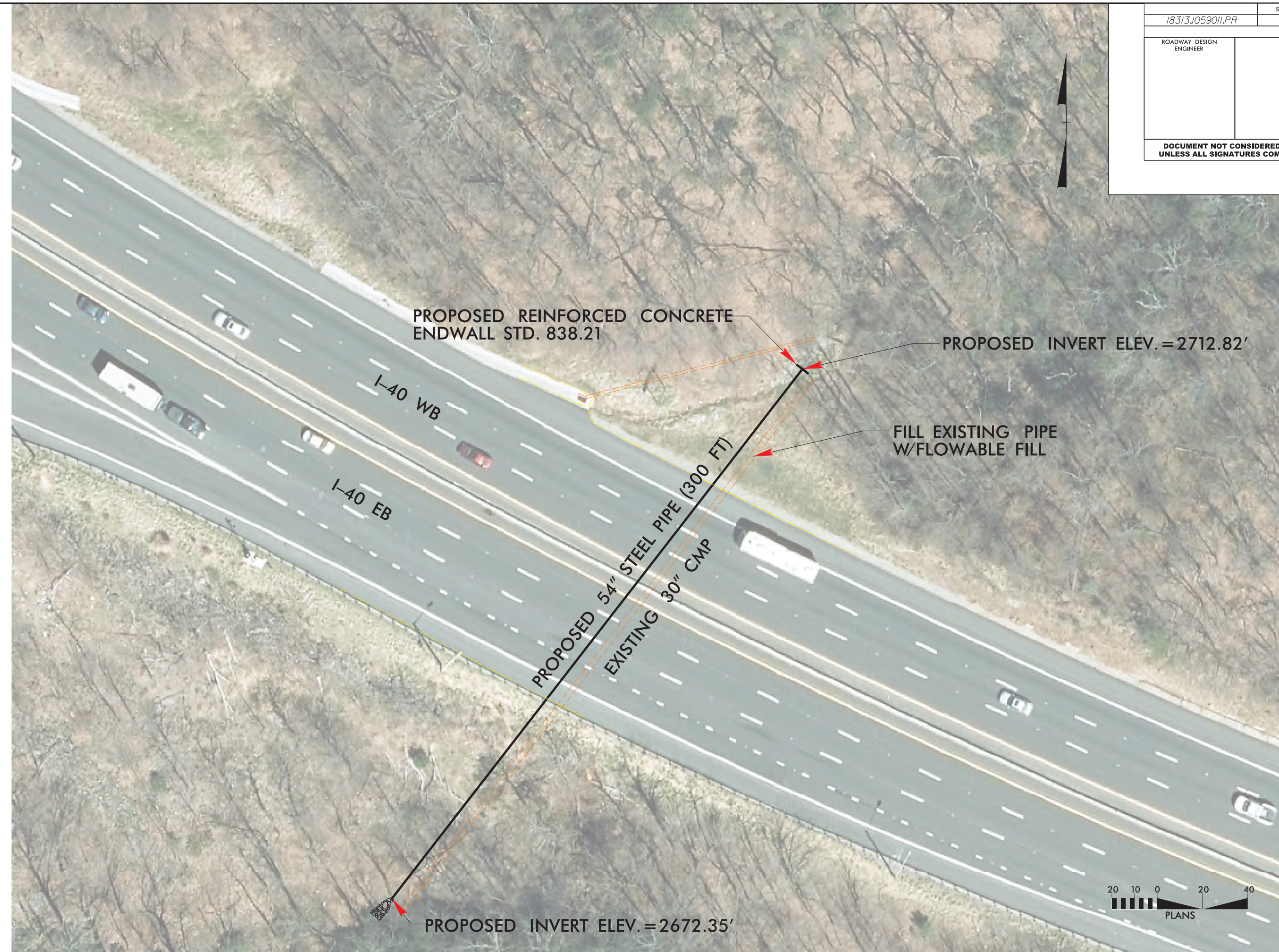

PROPOSED INVERT ELEV. = 2672.35'

PROJECT REFERENCE NO.	SHEET NO.
18313.1059011.PR	2
RW SHEET NO.	
ROADWAY DESIGN ENGINEER	HYDRAULICS ENGINEER
DOCUMENT NOT CONSIDERED FINAL UNLESS ALL SIGNATURES COMPLETED	

8/17/99
 REVISIONS
 C:\APR_2025_16_27\001\Projects\18313\18313\Roadway\Proc\140_01.dwg...
 C:\APR_2025_16_27\001\Projects\18313\18313\Roadway\Proc\140_01.dwg...

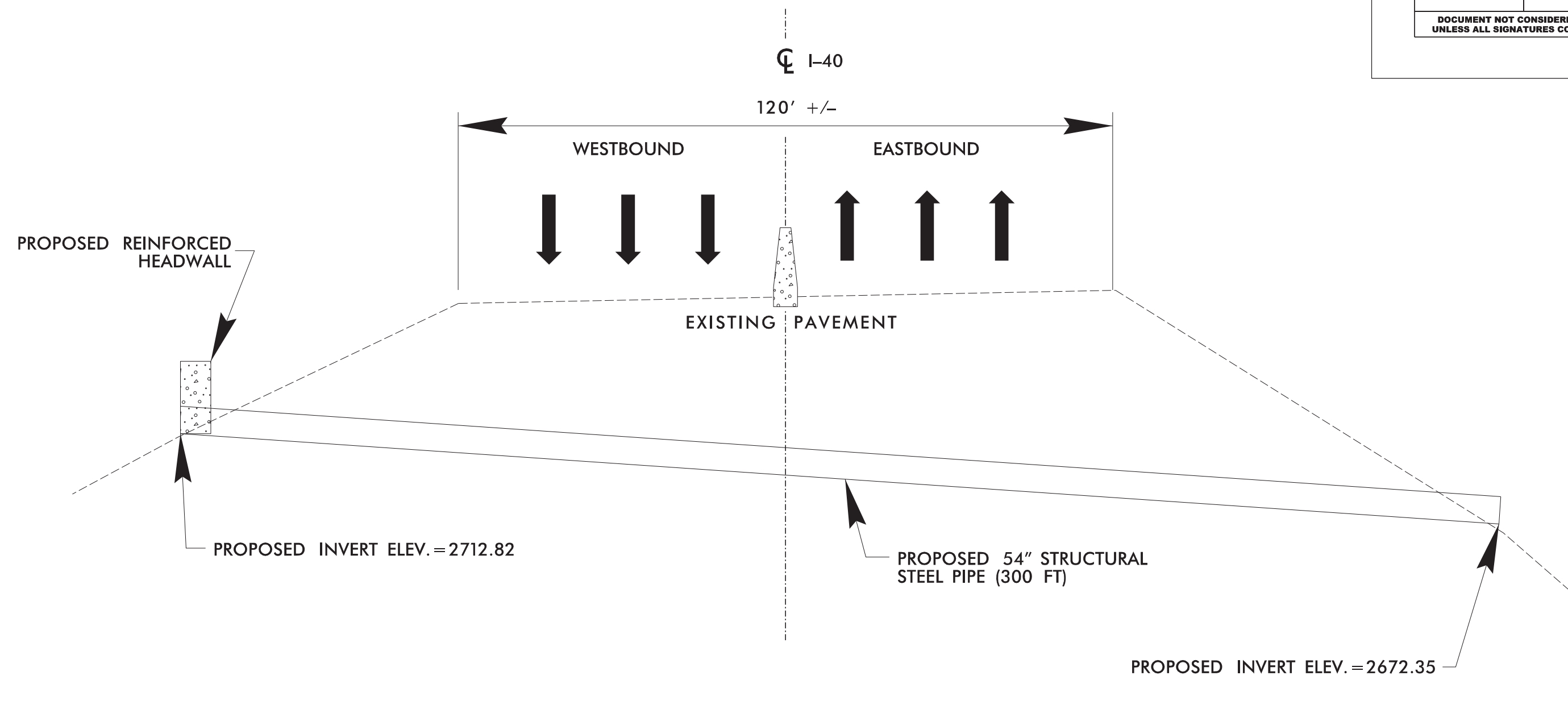

TYPICAL SECTION #1

PROJECT REFERENCE NO. 18313.1059011.PR	SHEET NO. 4
RW SHEET NO.	
ROADWAY DESIGN ENGINEER	HYDRAULICS ENGINEER

ONSITE CONCRETE WASHOUT STRUCTURE WITH LINER

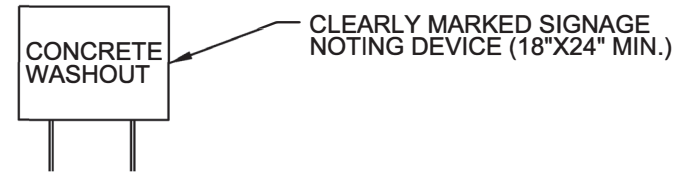
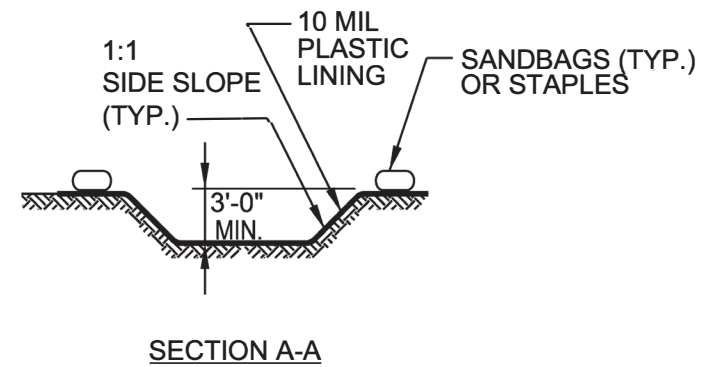
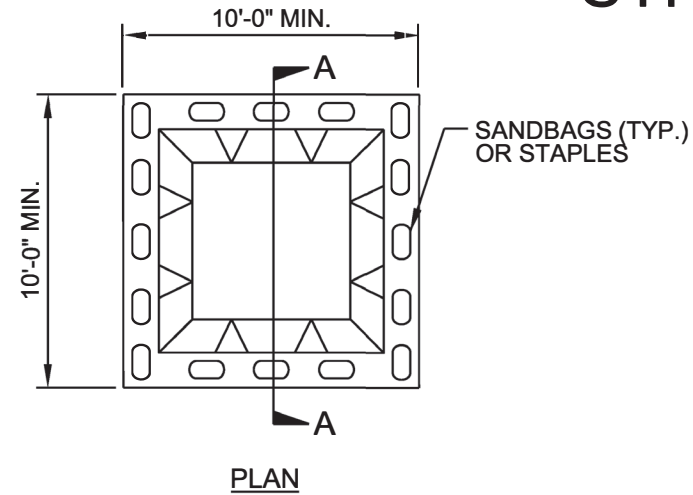

BELOW GRADE WASHOUT STRUCTURE
NOT TO SCALE

- NOTES:**
1. ACTUAL LOCATION DETERMINED IN FIELD
 2. THE CONCRETE WASHOUT STRUCTURES SHALL BE MAINTAINED WHEN THE LIQUID AND/OR SOLID REACHES 75% OF THE STRUCTURES CAPACITY TO PROVIDE ADEQUATE HOLDING CAPACITY WITH A MINIMUM 12 INCHES OF FREEBOARD.
 3. CONCRETE WASHOUT STRUCTURE NEEDS TO BE CLEARLY MARKED WITH SIGNAGE NOTING DEVICE.

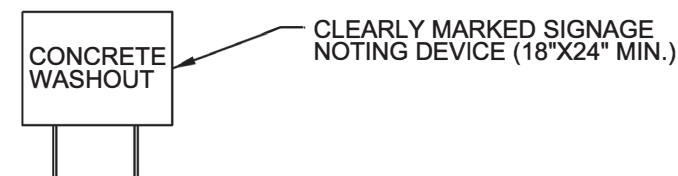
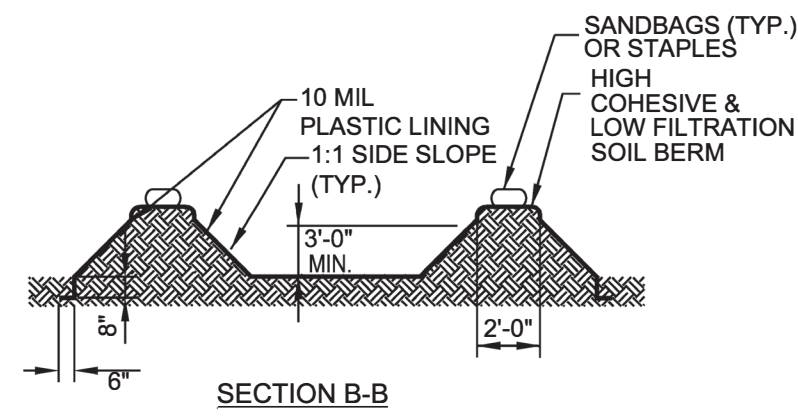
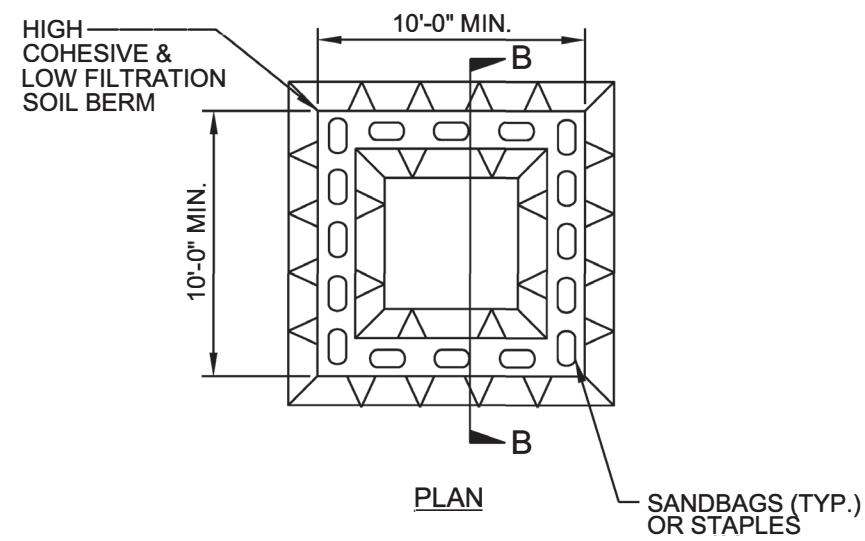

ABOVE GRADE WASHOUT STRUCTURE
NOT TO SCALE

- NOTES:**
1. ACTUAL LOCATION DETERMINED IN FIELD
 2. THE CONCRETE WASHOUT STRUCTURES SHALL BE MAINTAINED WHEN THE LIQUID AND/OR SOLID REACHES 75% OF THE STRUCTURES CAPACITY TO PROVIDE ADEQUATE HOLDING CAPACITY WITH A MINIMUM 12 INCHES OF FREEBOARD.
 3. CONCRETE WASHOUT STRUCTURE NEEDS TO BE CLEARLY MARKED WITH SIGNAGE NOTING DEVICE.